

As a C3-certified system, HIGHDRA features a geo-awareness feature that visually alerts pilots to airspace restrictions. However, the operator or pilot remains responsible for checking current restrictions and manually uploading the necessary data into the system.

Data acquisition and conversion

1. Retrieve the official ED-318 data of your respective EASA Member State.
2. Open the starcopter conversion tool at: <https://ed-318.starcopter.de/>

AMC Geozone Converter

Convert ED-318 geozone files to AMC-compatible GeoJSON.

Upload an ED-318 file

 Drag and drop file here
Limit 200MB per file • JSON

Browse files

3. Upload the original file – the tool will automatically convert it into the AMC-compatible format.

AMC Geozone Converter

Convert ED-318 geozone files to AMC-compatible GeoJSON.

Upload an ED-318 file

 Drag and drop file here
Limit 200MB per file • JSON

Browse files

 UGZ_ED-318.json 2.7KB

Download converted AMC GeoJSON File

4. Then download the converted file.

Transfer of data to Herelink

1. Connect the Herelink to your computer using a USB cable.
2. On the Herelink, swipe down from the top of the screen and tap “USB charging this device”.
3. Select “Transfer Files”.

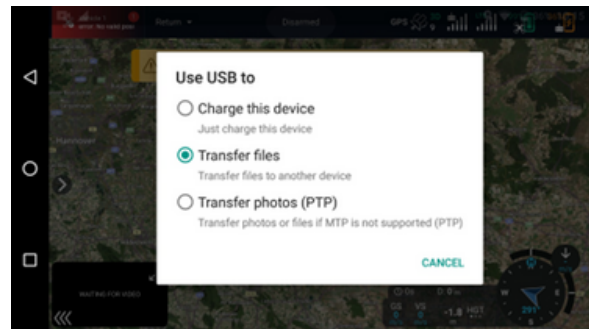

4. Your computer will now recognize the Herelink as a drive.
5. Copy the converted .geojson file to the Downloads folder of Herelink's internal shared storage.
6. Disconnect the USB connection.

Loading the data into AMC

1. Open AMC and switch to Fly View.
2. Tap the Map Tools menu → Map Overlays.



3. Tap the folder icon and navigate to: Downloads in storage Optimus
4. Select the previously transferred file.
5. The airspace restrictions are now displayed.



Geo-awareness in AMC

AMC issues a visual warning as soon as the drone approaches a geozone – at least 4 seconds before entry.

When entering a zone, full control remains with the pilot – there is no automatic intervention.

If the GPS signal is poor or missing, a warning will appear indicating that geo-awareness is impaired.

Additional features:

Tapping a geozone will provide details about its restrictions.

Time restrictions are currently not taken into account – all zones are considered permanently active.

Vertical boundaries are displayed, but AMC visually treats all zones as extending from the floor to infinity.

You can use the “eye” icon to show or hide geozones.

Geozones can be removed using the “trash can” icon.